

1. Brief

The FX5201 is a compact size embedded system with AMD low-power LX-800 processor board inside. This user's quick reference provides the I/O outlets description and their pin assignment.

2. Dimensions (in mm)

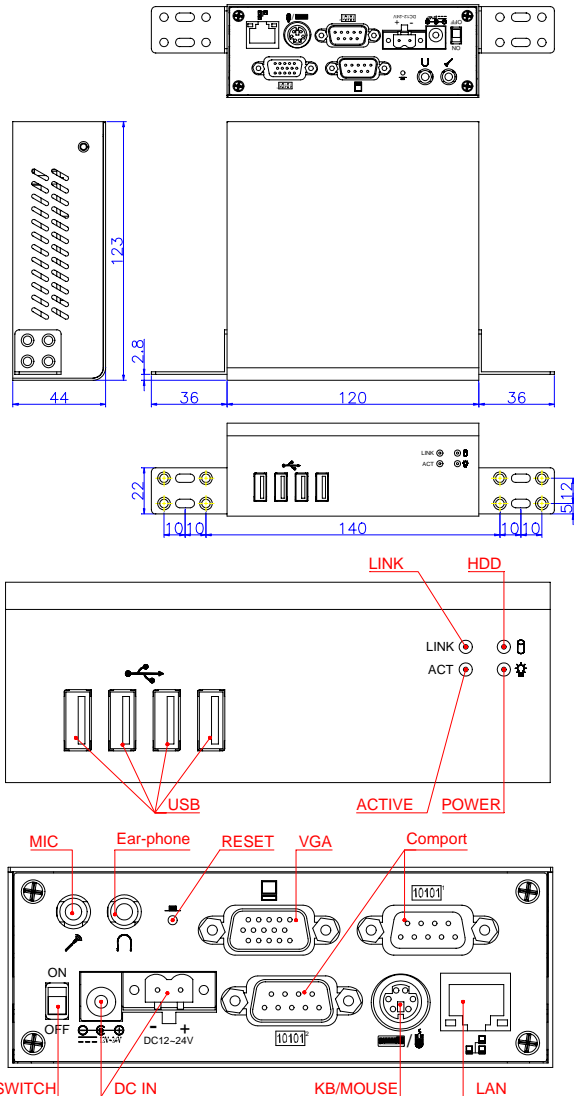

3. Packing List

- 1 FX5201 embedded system.
- 1 AC to DC power adapter and 1 AC power code cable.
- 1 Y-type (3-end) PS/2 keyboard plus mouse port adapter cable.
- 1 44-pin flat cable and 4 screws for fixing and connecting a 2.5" hard disk drive.
- 2 L-type universal fixers and 4 screws.
- 1 2-pin apartable terminal block.
- 1 LCD monitor back-mount kit (Optional)
- 1 compact disc includes software utility.

4. Features

- * **Processor Board**
AMD low power LX-800 processor with 256MB DDR RAM.
- * **I/O Outlets**
One 10/100 base-TX Ethernet ports.
4 USB ports (V2.0) and 2 RS-232 serial ports.
1 CRT and 1 PS/2 compatible keyboard/mouse interface.
1 Earphone and 1 Microphone connectors.
1 DC-In plug connector and 1 terminal block with 1 power switch.
1 power LED, 1 HDD/CF access LED, and 2 LAN LEDs.
1 Push button reset switch.
- * **Storage Bay**
1 CompactFlash socket for CompactFlash modules or MicroDrives.
One 2.5" hard disk space.
- * **Power requirement**
+12 ~ +24V DC with 15% tolerance, 10VA maximum with 2.5" HDD and 19V input voltage.
- * **Dimensions (1U height)**
123.0mm(D) x 120.0mm(W) x 44.2mm(H)

5. I/O outlets and LED Indicators

A. Power Connector

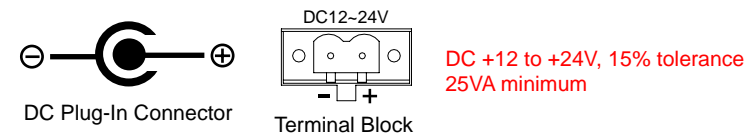

B. CRT and Audio Connectors

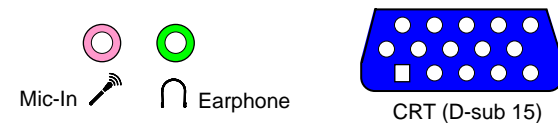

C. Keyboard/ Mouse and Serial Port Connectors

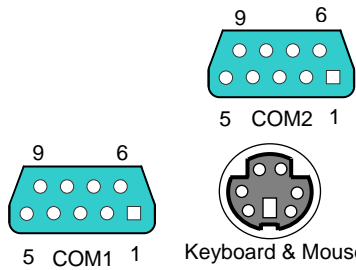

Standard PS/2 keyboard can be plugged into this connector without any adapter cable. If PS/2 keyboard and mouse will be used simultaneously, the included Y-type adapter cable is needed.

D. USB/LAN Connectors and LED Indicators (RJ45)

The LAN port is a RJ45 connector with 2 LEDs. The right side LED (orange) indicates data is accessing and the left side LED (green) indicates on-line status.

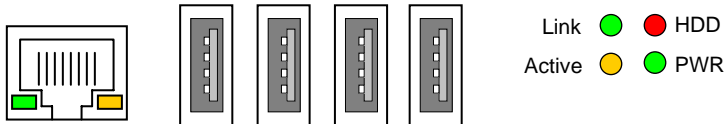

6. Software Configuration and Driver Installation

Please refer to the driver installing documentaion in the included Compact Disc for installing what device driver you need. If you need to change the system settings or configurations of I/O ports, Please refer to User's Manual (also in the included Compact Disc) for details.

7. Installing the L-type universal fixers on FX5201

Please refer to the next 2 figures for installing the FX5201 with L-type universal fixers.

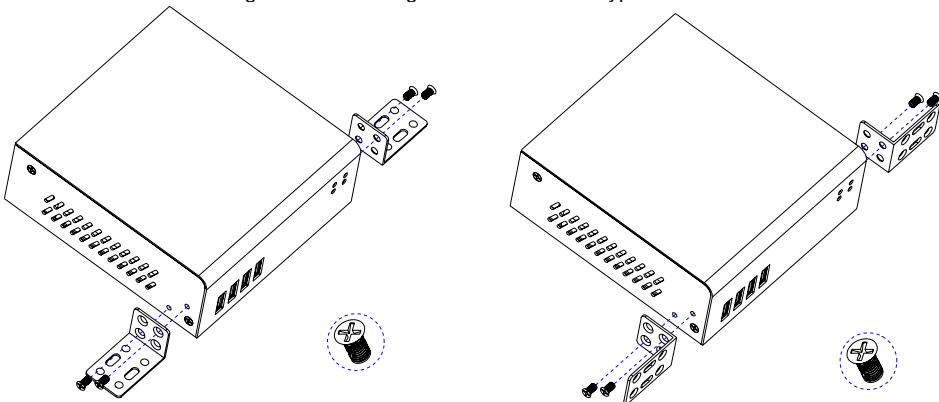

8. Installing CompactFlash, 2.5" HDD, and DDR RAM Module into FX5201

Step 1: Open the bottom cover after release 8 fix screws as shown on the right side figure.

Step 2: Install CompactFlash Module and 2.5" HDD to the HDD dock with included HDD screws as the down side figure shown.

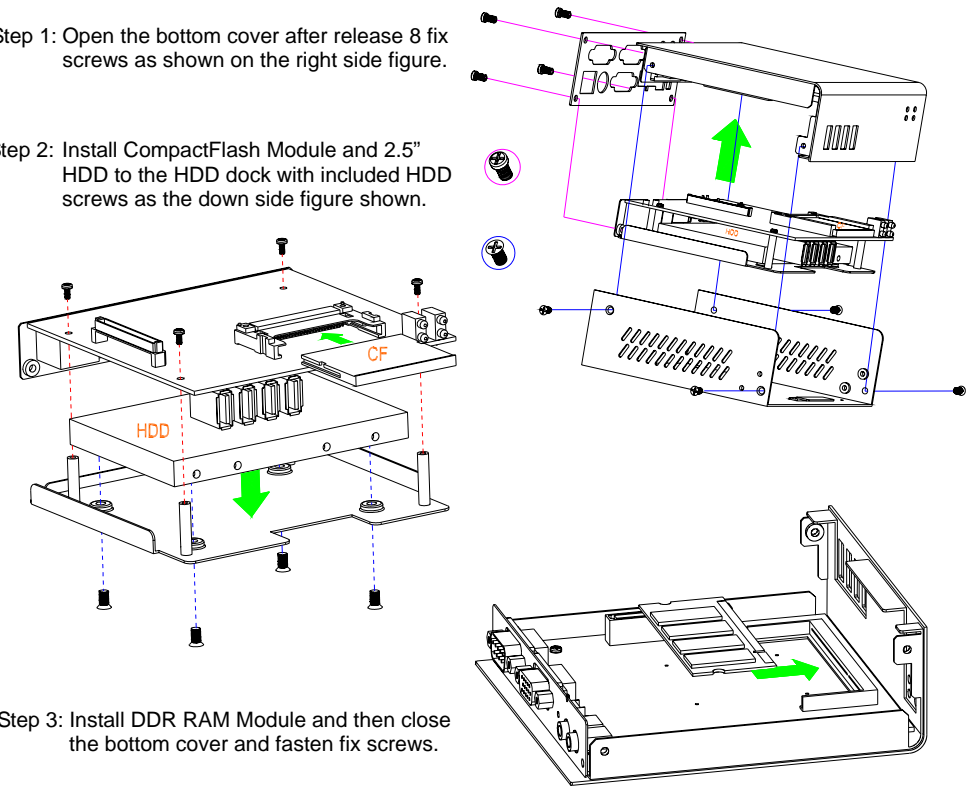

Step 3: Install DDR RAM Module and then close the bottom cover and fasten fix screws.

9. Installing the LCD Monitor Back-Mount Kit (Optional) on FX5201

