

## 1. Brief

The FP8081x is an 8-inch Panel PC with touch screen device (FP8081xT). This user's quick reference provides its outlook information and I/O outlets description.

## 2. Dimensions (in mm) and Rear I/O Information

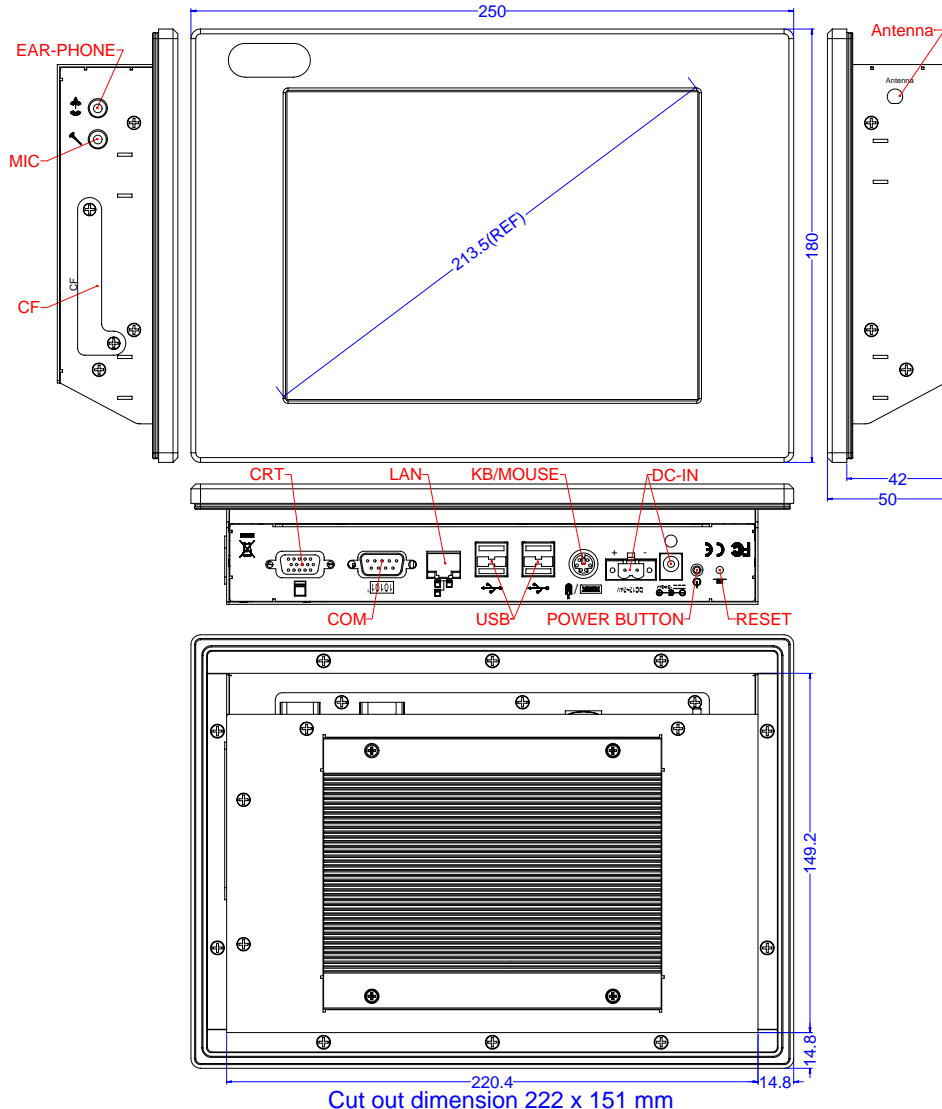

## 3. Packing List

### A. Standard Items

- 1 FP8081T industrial Panel PC.
- 1 AC to DC19V power adapter and 1 AC power cord cable.
- 1 pack of accessories including touch pen, embedded mounting kits, and SATA cables, etc.
- 1 2-pin apartable terminal block.
- 1 compact disc includes software utilities and manuals.

### B. Optional Items

- 1 Y-type (3-end) PS/2 keyboard plus mouse port adapter cable. (P/N: 7003000008G)
- Half size mini PCIe module adapter kit (AK1006, 1 piece of metal with 2 screws, P/N: 0606010028G)
- Din-Rail mounting kit (FP8081K1, P/N: 0606010026G, 2 pieces of metal with 6 fixed screws)

## 4. Features

### \* Processor Board

Intel® Atom™ N270 (1.6GHz, 512KB L2, FSB 533MHz, 2.5 Watts) processor with 1GB DDR2 RAM. (2GB Max.)

### \* I/O Outlets

- One 10/100/1000 base-TX Ethernet port.
- 4 USB ports (V2.0) and 1 RS-232/422/485 serial port.
- 1 VGA (CRT) and 1 PS/2 compatible keyboard/mouse interface.
- 2 Audio connectors for Earphone and Microphone.
- 1 mini PCIe socket and 1 SIM card socket for WLAN/GSM applications.
- 1 DC-In plug connector and 1 terminal block for DC power input.
- 1 power button and 1 reset button.

### \* Storage Bay

- 1 CompactFlash socket for CompactFlash modules or MicroDrives.
- One 2.5" SATA hard disk space.

### \* Power requirement

+12 ~ +24V DC, 2.16A maximum (1.36A typical) with 19V input voltage.

### \* Mechanical

Dimensions: 50mm(D) x 250mm(W) x 180mm(H)  
 Weight: 2.8Kg. (Standard packing)  
 Approval: IP65 Compliant.

## 5. I/O outlets and LED Indicator

### A. Power Connectors

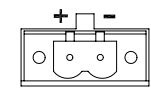

DC +12V to +24V, 48W minimum

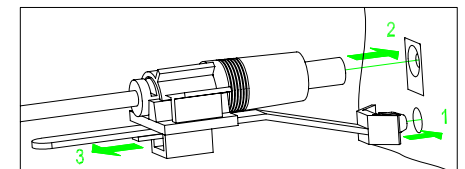

**B. Audio Connectors (Located on the left side), Keyboard/Mouse, VGA, Serial port, LAN, and USB Connectors**

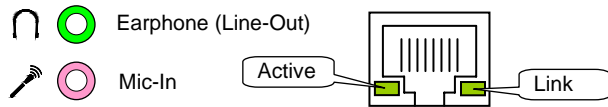

Note : Standard PS/2 keyboard can be plugged into this connector without any adapter cable. If PS/2 keyboard and mouse will be used simultaneously, an optional Y-type adapter cable is needed.

## 6. Installation

**A. Installing 2.5" Hard Disk, DRAM Module, Mini PCIe/SIM Card Module, and Antenna**

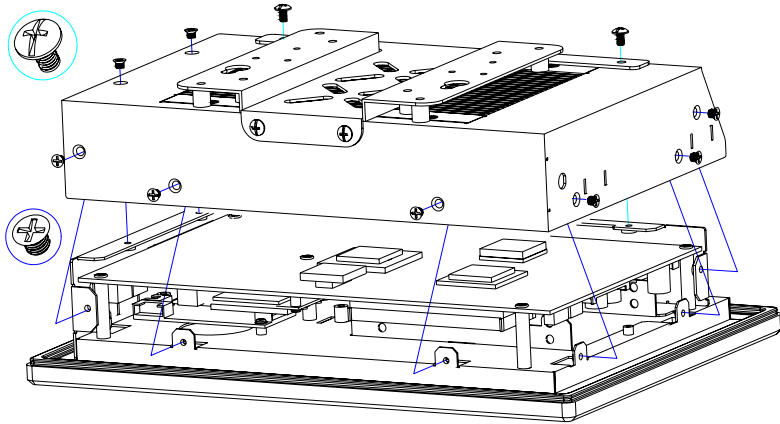

Step 1: Separate the back cover from housing. (10 screws)

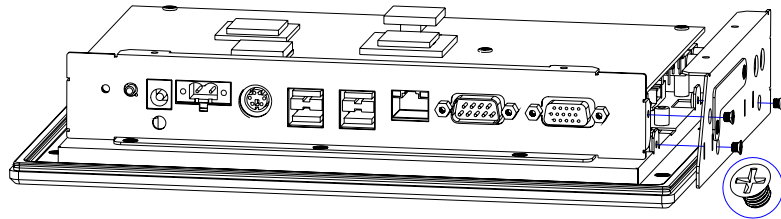

Step 2: Separate the left side cover from housing. (3 screws)

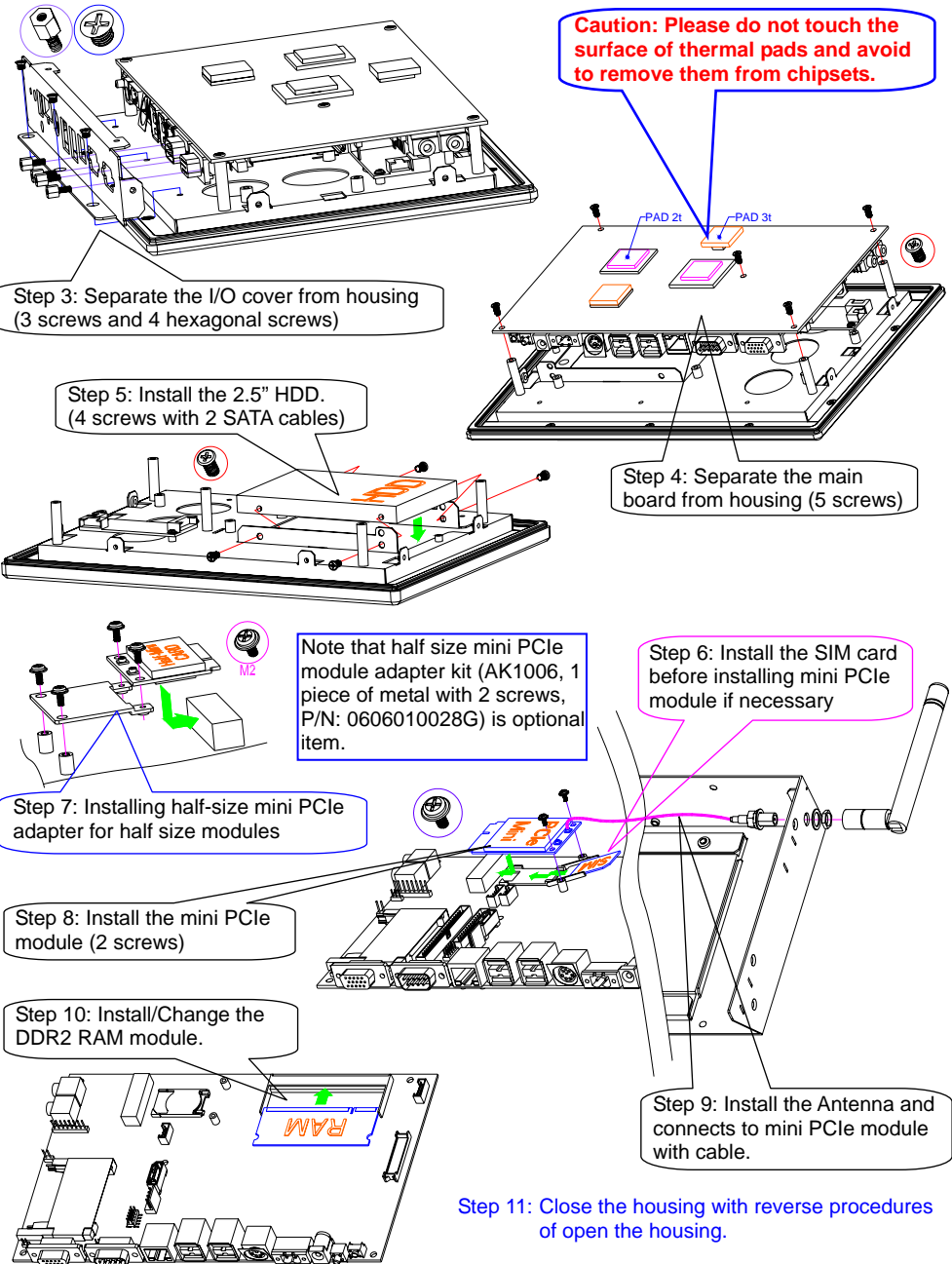

### B. Install CompactFlash Module to FP8081T (2 screws)

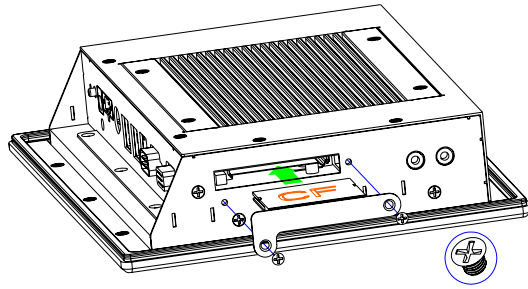

### C. Wall Mounting and Mounting Dimensions

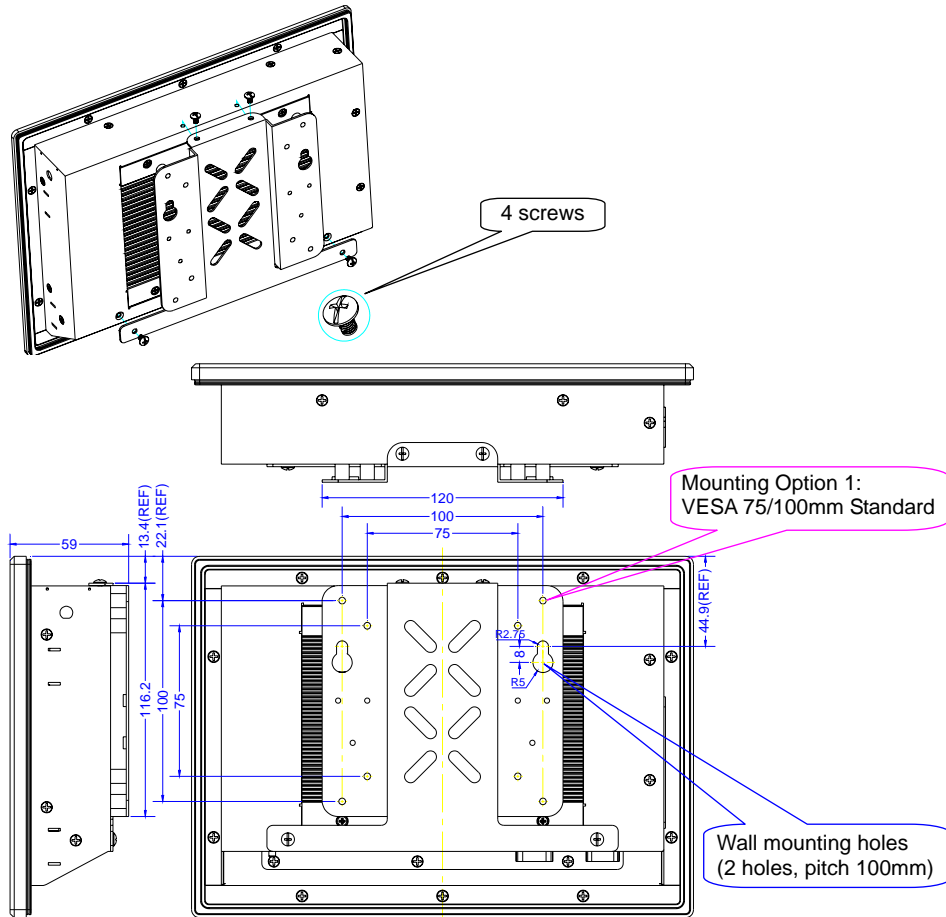

### D. Embedded Mounting and Mounting Dimensions

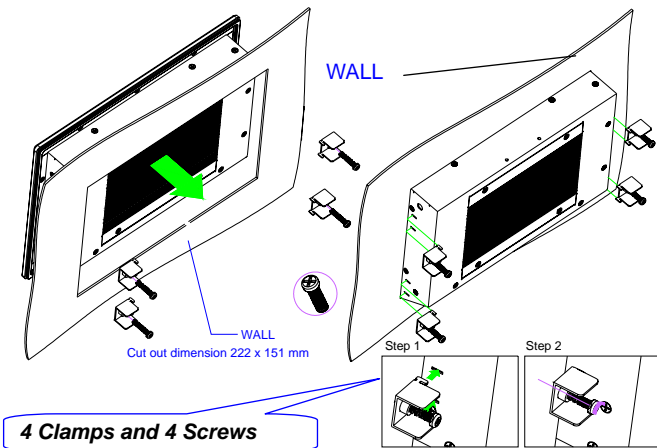

### E. Din-Rail Mounting with Din-Rail Mounting Kit (FP8081K1, Optional)

